

A Prestigious New Address is Coming to the heart of Zelenople

Have you ever driven along route 68 into Zelenople and admired the large, historic Tudor home at the corner of Jefferson Street? Majestic oaks shade the long walk from the street, and the beautiful grassy slope makes you think of family parties or swinging with a glass of lemonade and a sketch pad. . . How would you like to live next door? We may be able to help you out with that!



Pricing for the Somerset cottage:

Entrance Fee Type:

50% Refundable	\$225,000
90% Refundable	\$341,000
Second Person EF	\$6,000
Monthly Fee, Single	\$2,679
Monthly Fee, Double	\$3,606

Apply now to be eligible for these homes!

Lutheran
SeniorLife
Passavant
Community

March 1, 2018

Call Heidi for a chance to be the first to see our virtual tour.
724-452-3583

The Somerset

Ready to customize to suit your needs!

Construction to begin

March, 2018

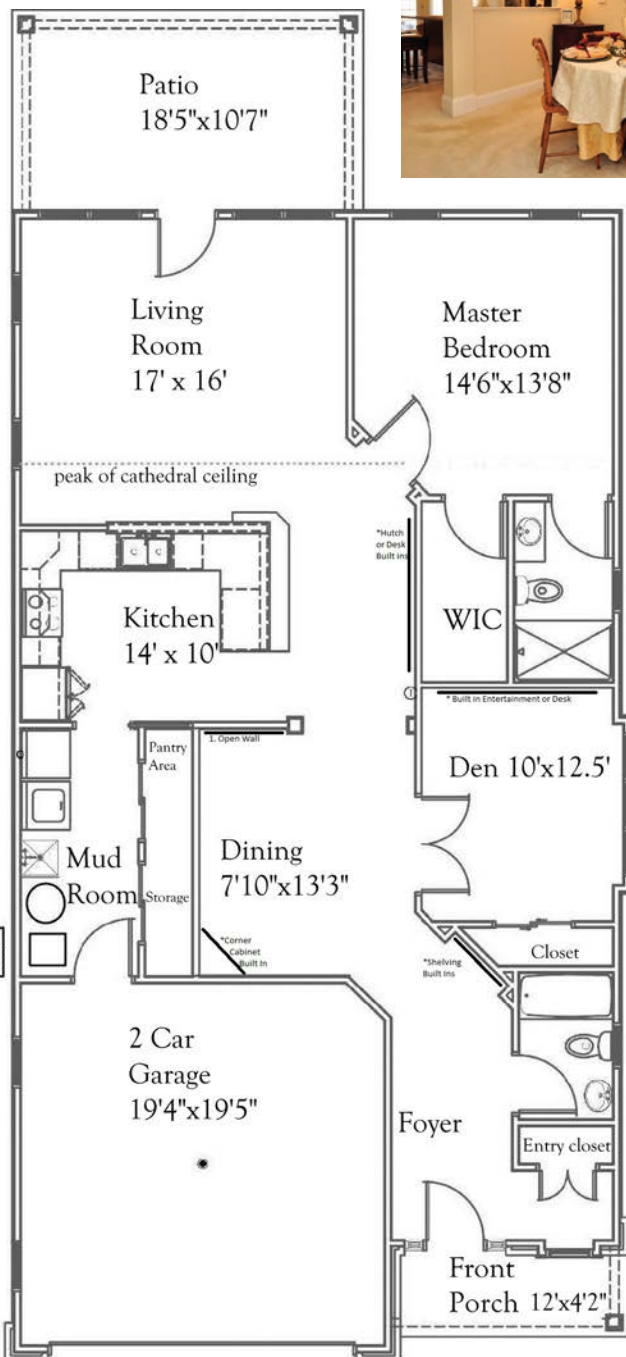
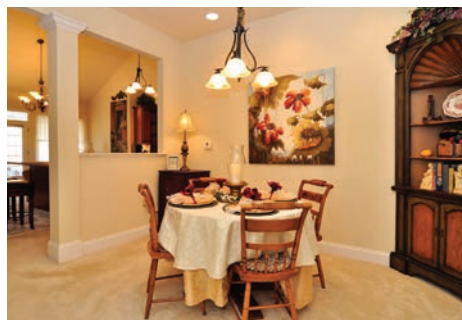

Only two homes remain – Don't wait!

A contemporary floor plan featuring:

- gorgeous great room with cathedral ceiling
- 1 bedroom/den or 2 BR
- 2 baths, one with walk in shower, one with tub/shower
- Covered entryway and large, covered patio
- 2 car garage
- laundry/mud room
- many finish options!

Options available:

- Skylights
- Open DR Wall¹
- Upgrade Woodwork
- Upgrade Flooring
- Custom Closets
- Under cabinet lighting
- Many Built in Options*!
- Humidifier
- Water Softener
- Garage Workplace
- Electric Fireplace/ Mantel
- Stainless Appliances

Call Heidi at 724-452-3583 for a chance to be the first to see our virtual tour. We suggest you not wait – with only 2 of these homes now available in this beautiful setting, they will go fast!